

Normas de Referência

Construção

BSI BS EN ISO 17292
ASME B 16.34

Testes

API 598

Conexões

ROSCA BSP - ISO 228
ROSCA NPT - ANSI/ASME B 1.20.1
SOLDA SW - ASME B 16.11
SOLDA BW - ASME B 16.25

Materiais

Corpo e Tampa

AISI - 304	ASTM A216 - WCB
AISI - 304L	ASTM A351 - CF8
AISI - 316	ASTM A351 - CF8M
AISI - 316L	ASTM A351 - CF3
AISI - 1020	ASTM A351 - CF3M

Esfera

ASTM A351 - CF8
ASTM A351 - CF8M
ASTM A217 - CA15
IC416
ASTM B16 - C360

Vedações

PTFE | COMP L

Haste

AISI - 304
AISI - 304L
AISI - 316
AISI - 316L
AISI - 1020
AISI - 410
AISI - 416
Outros materiais sob consulta



IMAGEM MERAMENTE ILUSTRATIVA

Dados Técnicos

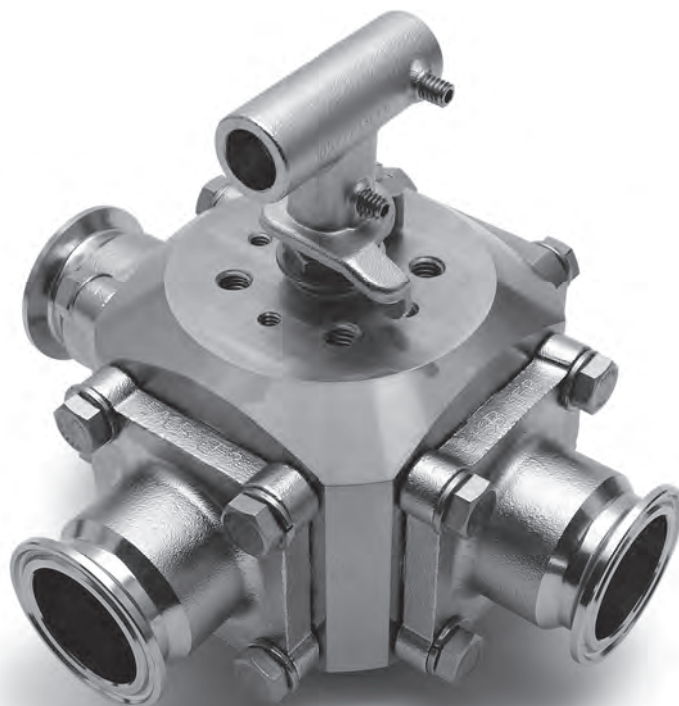
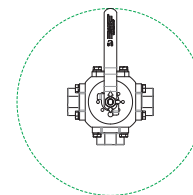
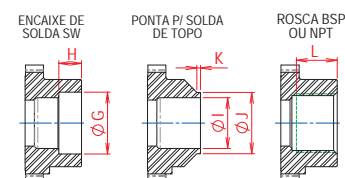
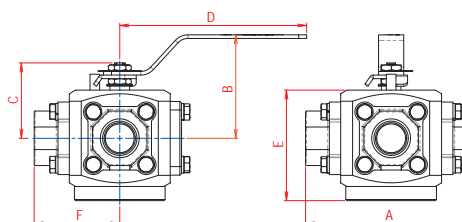

CONFIGURAÇÕES POSSÍVEIS:

CONF. 1 - 90°
POS. 1 - A/B/C
POS. 2 - B/C

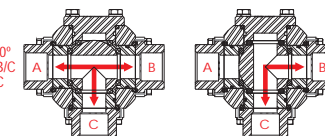

CONF. 2 - 90°
POS. 1 - B/C
POS. 2 - A/B

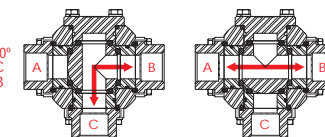

CONF. 3 - 90°
POS. 1 - A/C
POS. 2 - A/B/C

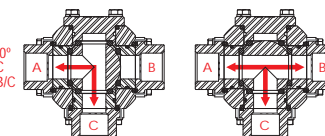

CONF. 4 - 90°
POS. 1 - A/B
POS. 2 - A/C

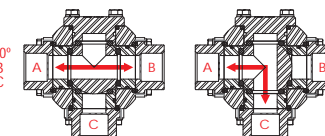

Especificações Técnicas

Válvula que permite a utilização em múltiplas posições mostradas nas configurações de montagem permitindo fluxo bidirecional com vedação estanque em todas as posições.

Haste a prova de expulsão, pode ser usada para bloqueio de fluxo. Podem ser acionadas manualmente ou automaticamente tendo bases de fixação conforme norma ISO 5211.

Existe uma gama muito grande de utilização, na indústria química, petroquímica, papel e celulose, siderúrgica, etc., em linhas de fluidos, gases ou vapor.

Disponíveis também nas extremidades flangeadas nas classes 150, 300, DIN PN 10 / 16 / 25 / 40 e conexões para tubulação OD, dimensões sob consulta.

VÁLVULA DE ESFERA TRIPARTIDA PASSAGEM REDUZIDA (PR)

BITOLA		PASS.	A	B	C	D	E	F	G	H	I	J	K	L
POL.	DN													
1/2"	15	11,1	101,0	77,0	51,0	125,0	66,0	50,5	21,8	9,5	15,8	21,8	2,0	17,0
3/4"	20	14,0	115,0	77,0	55,5	125,0	72,0	57,5	27,1	12,5	20,9	27,1	2,0	17,0
1"	25	20,4	130,0	90,0	63,5	165,0	83,0	65,0	33,8	12,5	26,4	33,8	2,0	23,0
1.1/4"	32	25,4	151,0	90,0	66,5	165,0	97,5	75,5	42,6	12,5	35,0	42,6	2,0	23,0
1.1/2"	40	31,7	163,0	122,0	84,0	170,0	110,0	81,5	48,7	12,5	41,0	48,7	3,0	28,0
2"	50	38,0	180,0	122,0	92,0	170,0	120,0	90,0	61,0	16,0	52,5	61,0	3,0	28,0
2.1/2"	65	50,8	196,0	140,0	108,0	256,0	140,0	98,0	73,8	16,0	62,7	73,8	3,0	28,0
3"	80	63,0	238,0	150,0	117,0	267,0	156,5	119,0	90,1	16,0	78,0	90,1	3,0	37,0

VÁLVULA DE ESFERA TRIPARTIDA PASSAGEM PLENA (PP)

BITOLA		PASS.	A	B	C	D	E	F	G	H	I	J	K	L
POL.	DN													
1/4"	8	11,1	101,0	77,0	51,0	125,0	66,0	50,5	14,0	9,5	9,3	14,0	2,0	11,0
3/8"	10	11,1	101,0	77,0	51,0	125,0	66,0	50,5	17,6	9,5	12,3	17,6	2,0	11,0
1/2"	15	14,0	115,0	77,0	55,5	125,0	72,0	57,5	21,8	9,5	15,8	21,8	2,0	17,0
3/4"	20	20,4	130,0	90,0	63,5	165,0	83,0	65,0	27,1	12,5	20,9	27,1	2,0	17,0
1"	25	25,4	151,0	90,0	66,5	165,0	97,5	75,5	33,8	12,5	26,4	33,8	2,0	23,0
1.1/4"	32	31,7	163,0	122,0	84,0	170,0	110,0	81,5	42,6	12,5	35,0	42,6	2,0	23,0
1.1/2"	40	38,0	180,0	122,0	92,0	170,0	120,0	90,0	48,7	12,5	41,0	48,7	3,0	28,0
2"	50	50,8	196,0	140,0	108,0	256,0	140,0	98,0	61,0	16,0	52,5	61,0	3,0	28,0
2.1/2"	65	63,0	238,0	150,0	117,0	267,0	156,5	119,0	73,8	16,0	62,7	73,8	3,0	28,0